

# PROHDMIEX50M

## 50m HDMI Extender over CAT5e/6 with IR, PoE, EDID and Distance Equalization

**PRO**ception

The HDMI extender over single CAT5e/6 with IR extends high definition video and audio signals up to 164ft/50m. Features EDID management, which allows and encourages source and display “handshake” for seamless integration. The extender is equipped with bi-directional IR pass-through which allows for remote control at both TVs.

### Package Contents:

- HDMI transmitter.
- HDMI receiver.
- 5V 1A DC power supply.
- Product manual.

### Features:

- Allows HDMI Audio/Video and IR signals to be transmitted over a single Cat5e/6 cable.
- Support copy EDID from receiver display or loop out display.
- Allows for cascading via additional HDMI loop out port.
- Support Power over cable function.
- Transmission Range: Extends 1080p resolution up to 164ft/50m over a single Cat5e or Cat6 cable.
- Works with HDMI and HDCP compliant devices.
- Supports up to 1080p High Definition resolution.

### Transmitting unit:

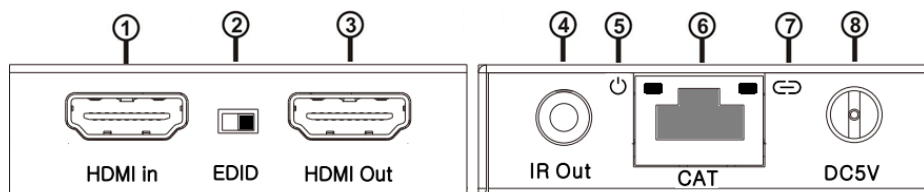

- ① **HDMI in:** Connect the HDMI output port of your source equipment such as DVD/Blu-ray players or Set-Top-Box with an HDMI cable.
- ② **EDID:** The switcher can switch copy EDID function, switch to the right and the extender will copy HDMI loop out display EDID information to source. Switch to the left and the extender will copy Receiver display EDID to source.
- ③ **HDMI out:** Connect the HDMI input of your display (such as an HDTV).
- ④ **IR out:** Connect the IR Blaster cable included in the package for IR signal transmission. Place the IR blaster in direct line-of-sight of the equipment to be controlled.
- ⑤ **Power LED.**
- ⑥ **CAT:** CAT5e/6 cable connection.
- ⑦ **Link LED:** This LED will illuminate when the device is connected to HDMI source.
- ⑧ **DC 5V:** 5V DC power supply connection.

### Receiver unit:

# PROHDMIEX50M

50m HDMI Extender over CAT5e/6 with IR, PoE, EDID and Distance Equalization

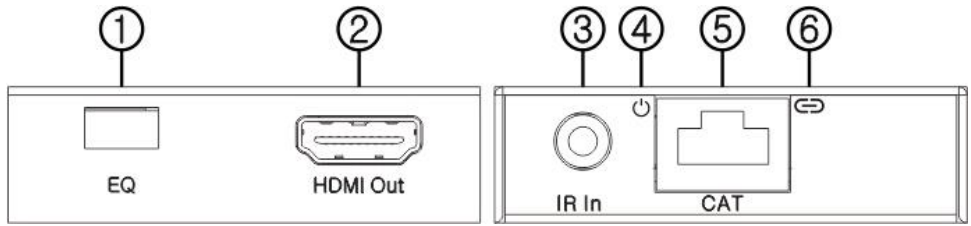

- ① **EQ switcher:** equalizer switcher.
- ② **HDMI out:** HDMI connection to display.
- ③ **IR in:** Connect to the IR Receiver for IR signal reception. Ensure that remote being used is within the direct line-of-sight of the IR receiver.
- ④ **Power LED.**
- ⑤ **CAT:** CAT5e/6 cable connection.
- ⑥ **Lock LED:** This LED will illuminate when the HDMI signal from the transmitter is stable.

### RX Equalizer distance adjust

If you see picture flickering, white flecks or a snowy picture set the EQ dip switches to the recommended setting depending on length of CAT cable. If no picture, then check resolution of the playback device is 1080p or less. For resolutions over this please use our PROHDMIEX50M-4K.

Recommended EQ setting	
Position	Cable Length
 0      1	under 15m (49.5ft)
 2      3	15-30m (49.5 ft - 99ft)
 4      5	30-40m (99ft - 132ft)
 6      7	40-50m (132ft – 164ft)

## PROHDMIEX50M

50m HDMI Extender over CAT5e/6 with IR,  
PoE, EDID and Distance Equalization

# PROception



### Instructions:

*Always disconnect power before inserting or removing any cable from any device.*

1. Connect the device, such as a Blu-ray player, game console, A/V receiver, cable, or satellite receiver etc., to the HDMI input on the transmitting unit.
2. Connect a display such as an HDTV or HD projector to the HDMI output on the receiving unit.
3. Connect a single category 5e/6 up to 164ft/50m to the output of the transmitting unit, and the other end to the input of the receiving unit.
4. Power both the transmitter and receiver with the power supply included.
  - If no signal is being displayed, check the receiver EQ switcher. If no signal, see EDID section or adjust the resolution (lowest to highest until signal is displayed). A 24Hz vertical refresh rate may work better than 60Hz or higher. Use the source remote at the receiver emitter to test IR functionality. If the IR remote function is not responding, check the emitters to ensure they are placed correctly and are plugged into the correct IR jacks on the extender set receiving and transmitting units.

**PROHDMIEX50M**  
**50m HDMI Extender over CAT5e/6 with IR,**  
**PoE, EDID and Distance Equalization**



**IR RECEIVER**

**IR BLASTER**

**IR BLASTER (TX)**

**To control the source:**

Plug IR Blaster into IR TX port of transmitter unit, place blaster in front of the IR eye of the source.

**To control the display:**

Plug IR Blaster into IR TX port of receiver unit, place blaster in front of the IR eye of the display.

**IR RECEIVER (RX)**

**To control the source:** Plug IR Receiver into IR RX port of receiver unit; place receiver at or near display.

**To control the display:** Plug IR Receiver into IR RX port of transmitter unit; place receiver in position where it can receive remote signals.

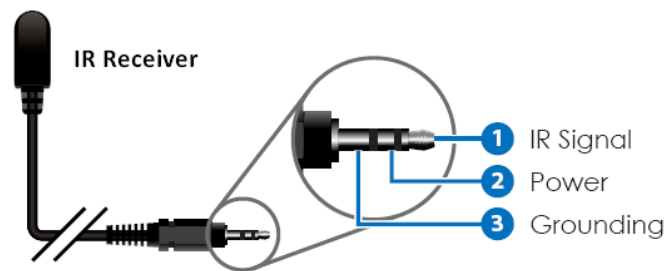
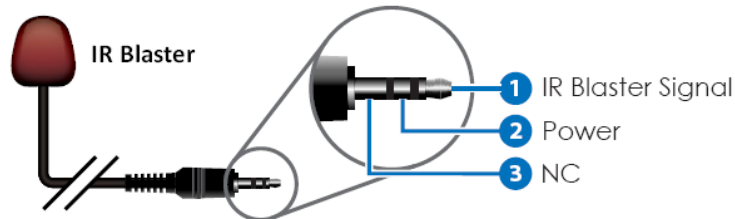

**Specifications:**

sales@blake-uk.com  
www.blake-uk.com  
0114 223 5000  
PD2011-8765-05

## PROHDMIEX50M

50m HDMI Extender over CAT5e/6 with IR,  
PoE, EDID and Distance Equalization

The logo for PROception, with 'PRO' in a light blue color and 'ception' in white, set against a black rectangular background.

Video Bandwidth:	Single link 165Mhz [ 4.95Gbps]
Video Support:	480i/480p/720p/1080i/1080p @60Hz
Audio Support:	Surround Sound (up to 7.1 ch) or stereo digital audio
Transmission Range:	HD [1080p 24-bit color] – up to 50m [164ft]
Input TMDS Signal:	3.3 volts
Input DDC Signal:	5.0 volts/P-P
Human Body model:	+/- 8 kV (air-gap discharge) +/- 4 kV (contact discharge)
3.5mm connector:	(TX and RX) IR Receiver/IR Blaster
Power Supply:	(1) 5V1A DC
Power consumption:	1.5 watts (TX); 1.0 watts (RX)